

Product information

87 22 250 SB

KNIPEX Cobra® QuickSet
High-Tech Water Pump Pliers

DIN ISO 8976



- Fully open, push, grab!
- Additional fast adjustment on the workpiece by sliding the pliers handle
- Combines the proven, reliable locking of the hinge bolt with an additional push function which makes it easier to work in very confined and inaccessible areas
- The adjustment directly on the workpiece is possible by simply sliding the pliers handle
- Reliable locking of the hinge bolt with the first workload. The gripping width of the pliers is then fixed and can only be adjusted by pressing the button.
- To re-activate the sliding function, the hinge bolt must be released by pressing the push button and the pliers must be completely opened again
- Self-locking on pipes and nuts: no slipping on the workpiece and low handforce required
- Gripping surfaces with special hardened teeth, teeth hardness approx. 61 HRC: high wear resistance and stable gripping
- Box-joint design for high stability due to double guide
- Pinch guard prevents operators' fingers being pinched

General	
Article No.	87 22 250 SB
EAN	4003773077800
Pliers	grey atramentized
Head	polished
Handles	with slim multi-component grips
Weight	388 g
Dimensions	250 x 84 x 18 mm
Standard	DIN ISO 8976
REACH compliant	does not contain SVHC
RoHS compliant	not applicable
Technical details	
Adjustment positions	25
Capacity for pipes, inches (diameter)	Ø 2 Inch
Capacities for nuts	46 mm
Capacities for pipes (diameter)	Ø 50 mm

technical change and errors excepted

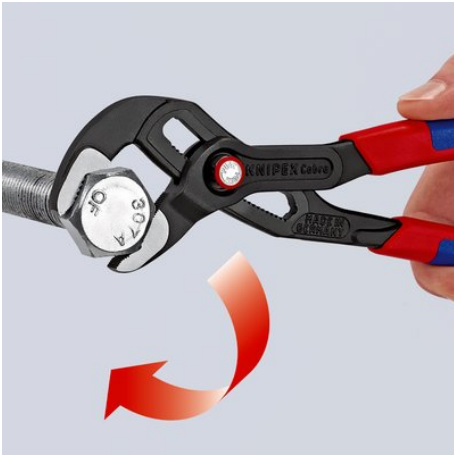

Hinge bolt locks itself with the first workload

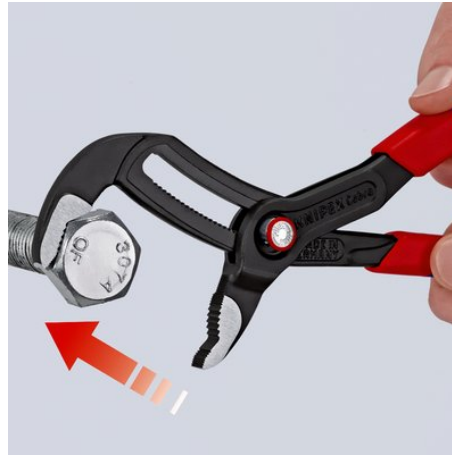

Position jaw – simply slide and close pliers



Press the button – open pliers completely